

FRANCE

Ceres
Imperforate
1849-50



10C
DARK BISTER
ON YELLOW

10C
GREENISH
BISTER

15C
YEL. GREEN
ON GREENISH

15C
GREEN ON
GREENISH

2



20C
BLACK ON
BUFF

20C
DARK BLUE

20C
BLUE ON
BLUISH

20C
BLUE ON
YELLOWISH

3b

4

4b



25C
BLUE ON
BLUISH



TYPE I
40C
ORG. VER. ON
YELLOWISH

TYPE II
40C
ORANGE ON
YELLOWISH

1F
DULL ORG.
RED

1F
VER. ON
YELLOWISH

1F
PALE VER.

1F
DARK CAR.
ON YELLOW

1F
BROWN
CARMINE

1F
LIGHT
CARMINE

4

9

President Louis Napoleon
Imperforate
1852

10C
PALE BISTER
ON YELLOW

10C
DARK BISTER
ON YELLOW

25C
BLUE ON
BLUISH

25C
DARK BLUE
ON BLUISH

10

11

11b

FRANCE

Emperor Napoleon III
Imperforate
1853-60



1c
BRNZ. GREEN
ON PALE BL.
124



DIE I
10c
BIS. BRN. ON
YELLOWISH
146



DIE I
20c
BLUE ON
LILAC
15



DIE I
20c
BLUE ON
LILAC
150



DIE I
20c
BLUE ON
GREENISH
16a

DIE II
20c
BLUE ON
GREENISH
16

25c
BLUE ON
BLuish
17



1f
LAKE ON
YELLOWISH
21



19



18

FRANCE

Emperor Napoleon III

Perforated

1862-71



Napoleon III with Laurel

1863-70



30c
DK. BRN. ON
YELLOWISH
34a



5F
GRAY LILAC ON LAV.
37



FRANCE

Bordeaux Issue
Imperforate
1870-71



1C
BRONZE GRN.
ON PALE BLUE



TYPE B
2C
BRICK RED
ON YEL.

TYPE B
2C
CHESNUT ON
YELLOWISH

TYPE A
2C
CHOCOLATE
ON YEL.

39c



4C
GRAY

5C
YEL. GRN. ON
GREENISH



5C
EMERALD ON
GREENISH

TYPE A
10C
BISTER ON
YELLOWISH

42

TYPE B
10C
BISTER ON
YELLOWISH

42a



FIRST
TYPE
20C
BLUE ON
BLUISH



20C
DK. BLUE
ON BLUISH



SECOND
TYPE
20C
BLUE ON
BLUISH



20C
ULTRAMARINE
ON BLUISH

44b



THIRD
TYPE
20C
BLUE ON
BLUISH



20C
ULTRAMARINE
ON BLUISH

45a



225.00



30C
BLK. BRN.
ON YELLOWISH



47

40C
YEL. ORG. ON
YELLOWISH

40C
RED ORG. ON
YELLOWISH

40C
SCARLET ON
YELLOWISH



250.00

80C
DULL ROSE
ON PINKISH

48a

Napoleon with Laurel Surcharged
1871

10C ON 10C
BISTER

49

FRANCE

Ceres
Perforated
1870-73



10C
BISTER ON
YELLOWISH

54



TYPE I
40C
ORG. YEL. ON
YELLOWISH

59a



TYPE II
40C
ORG. YEL. ON
YELLOWISH

59c

150.00

Larger Numerals
1872-75



17.20



CHECK



51

CHECK



620



66



54

FRANCE

Peace and Commerce

Type I - The "N" of "INV" is under the "B" of "REPUBLIQUE"
1876-78



Peace and Commerce

Type II - The "N" of "INV" is under the "U" of "REPUBLIQUE"
1876-77



TYPE II INDIST

FRANCE

Peace and Commerce

Type II - The "N" of "INV" is under the "U" of "REPUBLIQUE"
1877-80



91a



1C
BLACK ON
PRUS. BLUE



2C
BROWN ON
YELLOW

86a



10C
BLACK ON
ROSE LILAC

91a



25C
BLACK ON
YELLOW

94

35C
BLACK ON
YEL. ORG.

94a

15.00

25.00



40C
VIOLET ON
LAVENDER

96



SM TEAR



92



93

FRANCE

Peace and Commerce

Type II - The "N" of "INV" is under the "U" of "REPUBLIQUE"
1879-90



100



Quadrille Paper
1892

Ordinary Paper
1898



Peace and Commerce

Type I - The "N" of "INV" is under the "B" of "REPUBLIQUE"
1898-1900



108



106



103



104a



99

FRANCE

Liberty, Equality, Fraternity (Blanc Issue)
1900-29



109 N^o

115



111 N^o

111a

"The Rights of Man" (Mouchon Issue)
1900-29



120

Numerals Printed Separately



10.00

REPLACE

"The Rights of Man" (Mouchon Issue Redrawn)
1902



110

119 IND FREE

113

FRANCE

Liberty and Peace (Merson Issue)
1900-29



121



122



40c
RED & PALE BLUE

123



45c
GREEN & BLUE

127



124



75.00



126



125



124



125

FRANCE

Lined Sower Issue

1903-38



Sower with Ground

1906

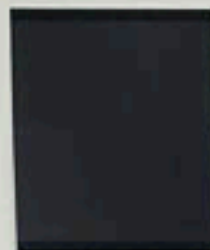

148 2.22

142 5.22

FRANCE

Cameo Sower
1906-37



1c
OLIVE BISTER

156



5c
ORANGE

160



Thin Numerals and Letters in Inscriptions
1906-27

1756



H 150.00



169a

FRANCE

Louis Pasteur
1923-26



195 H



Merson Issue Overprinted for
Bordeaux Philatelic Congress
1923

Pierre
de Ronsard
1924



Paris Olympic Games
1924



FRANCE

International Exhibition of Decorative Modern Arts
1924-25



229



10c



Sower and Pasteur Issues Surcharged
1926-27



55c ON 60c

236



FRANCE

Singles from
Philatelic Exhibition Sheet
1925



Singles from
Strasbourg Exhibition Sheet
1927

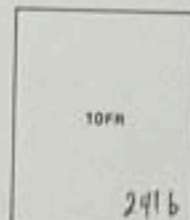
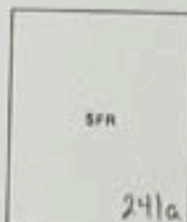

Visit of American Legionnaires
1927



Marcelin Berthelot
1927



Joan of Arc
1929



NH



NH

Merson Issue Overprinted for Le Havre Philatelic Exhibition
1929

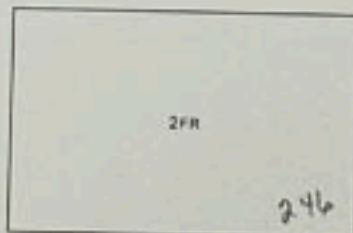

243 H

FRANCE

Reims Cathedral, Mont-Saint-Michel, Port of La Rochelle, Pont du Gard
1929-33

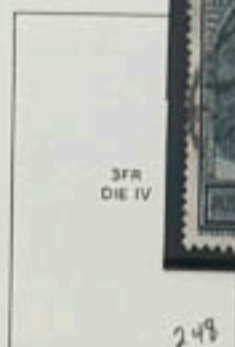

248

249



251

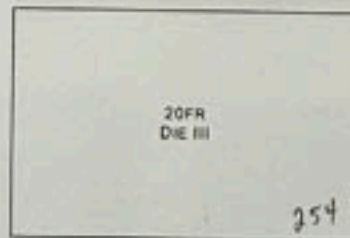
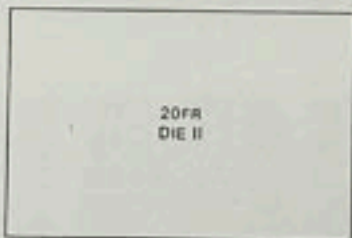
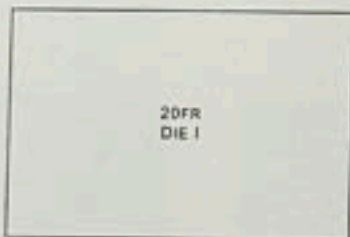

254

FRANCE

View of Algiers
1929



Sower and Pasteur Issues Overprinted
for Congress of International Labor Bureau



1930



SET NH 47.50

Arc de Triomphe
1931



NH 85.00

Colonial Exposition Issue
1930-31



2630



Dove and
Olive Branch
1934



Aristide Briand, Paul Doumer, Victor Hugo
1933



Joseph
Marie Jacquard
1934



Le Puy-en-Velay
1933



FRANCE

Peace with Olive Branch
1932-39



264 0



267



Peace Issue Surcharged
1934



266



281



281 5.25



282



273 RIBBED

PARIS

FRANCE

Jacques Cartier
1934



507 NH 210.00



Brenton River Scene
1935



S. S. Normandie
1935



296 0



H



19.00



1.50FR
BLUE GREEN

300b

St. Trophime at Aries
1935



297 0

Benjamin Delessert
1935



Windmill at Fontvieille
1936



Cardinal Richelieu
1935

Andre Marie Ampere
1936

Victor Hugo
1935



Jacques Callot
1935



FRANCE

Rouget de Lisle and "La Marseillaise"
1936

Pilatre de Rozier
1936



40c

310

Canadian War Memorial
1936



H
"Peace"
1936

1937 Paris Exposition Publicity
1936



1.50FR

320



320

FRANCE



Jean Leon Jaures
1936



Pierre Corneille
1937



Skiing
1937

7.00 H



Jean Mermoz
1937



13th International Railroad Congress
1937

France Congratulating USA
1937



Paris Exposition Issue
1937

Rene Descartes
1937



327 @ 1.75 3.75

328 @ 8.25

329 @ 1.25

FRANCE

Singles from International Philatelic Exhibition Sheet
1937



Leon Gambetta
1938

Peace Issue
Surcharged
1937



Mountain Road at Iseran
1937



Ceres
1938-40



Clement Ader
1938



H 95.00



Soccer Players
1938



13.50



FRANCE

Arc de Triomphe of Orange and Other Designs
1938



Champagne Costume
1938

de La Fontaine
1938

Paul Cezanne
1939



Visit of King George VI
and Queen Elizabeth
1938



New York World's Fair
1939

Clemenceau and Battleship
1939



FRANCE

Mercury
1938-42



Iris
1939-44



FRANCE

St Gregory of Tours
1939



Centenary of Photography
1939



Pumping Station at Marly
1939



Cathedral of Strasbourg
1939



Georges Guynemer
1940



"The Oath of the Tennis Court"
1939



Porte Chaussee
1939



View of Pau
1939



Maid of Languedoc, Bridge at Lyons
1939



FRANCE

Stamps of 1938-39 Surcharged
1940-41



Stamps of 1932-39 Surcharged
1940-41



FRANCE

Marshal Petain
1941



Beaune Hospital, View of Angers, Ramparts of St. Louis, Aiguesmortes
1941



Frederic Mistral
1941

Beaune Hospital
1942

Jules Massenet
1942



Stendhal
1942

Andre Blondel
1942

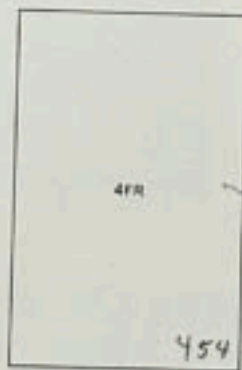
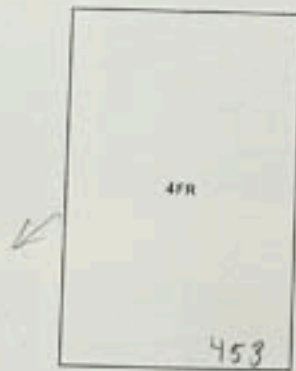

FRANCE

Marshal Petain
1941-42



FRANCE

Mercury
1942



Town-Hall Belfry
1942



Lavoisier
1943



Edouard Branly
1944



Coats of Arms
1943



Lake Lerie
1943



Hospital of Beaune
1943



Early Postal Car
1944



FRANCE

Coats of Arms
1944



Chateau de Chenonceaux
1944



Chateau
1944

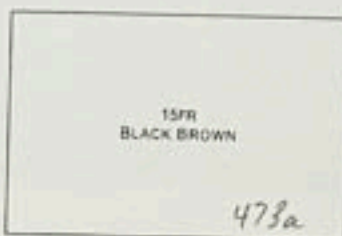

Claude Chappe
1944



Church of St. Dennis
1944



Bugeaud
1944



Liberation
1945



FRANCE

ALLIED MILITARY GOVERNMENT STAMPS

Arc de Triomphe

1944



Arc de Triomphe, Denominations in Black

1945



FRANCE

Gallic Cock, Marianne
1944

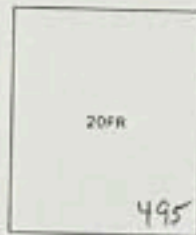

Mercury Type Overprinted "RF"
1944



FRANCE

Marianne
1944-45

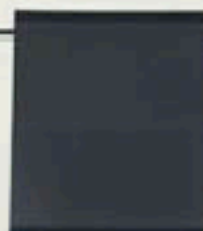

FRANCE

Coat of Arms, Ceres, Marianne
1945-47



546



535



536A



541A



544



547



FRANCE

Marianne
1945-46

650



652

Marianne
1945



Costumes and Cathedrais
1945

Arms of Metz and Strasbourg
1945

French Possessions
1945



Coats of Arms
1946



562 SHADE

562 SHADE

565 B

FRANCE

Peace Conference
1946

Globe and Wreath
1946

Semi-Postal
Surcharged
1946



Vezelay, Luxembourg Palace, Rocamadour, Pointe du Raz
1946



Cannes, Stanislas Square
1946-48



FRANCE

Ceres, Marianne
1947



12th UPU Congress
1947



Auguste Pavie
1947



Francois Fenelon
1947



Boy Scout Jamboree
1947



Captured Patriot
1947



583



584

FRANCE

View of Conques
1947

Ceres Issue
Surcharged
1947



de Chateaubriand
1948



General Leclerc
1948



Luxembourg Palace, View of Conques
1948



Marianne
1948-49



FRANCE

Centenary of First Stamps
1949



Centenary of
First Stamps
1949



Chailiot Palace
1948



Arctic Scene
1949

Genissiat Dam
1948



Marianne Issue
Surcharged
1949



Paul Langevin, Jean Perrin
1948



FRANCE

Coats of Arms
1949



Church, Dauphine Arms
1949



Franco-American Friendship
1949



Cloister
1949



1st French Stamp
1949

Jean Racine
1949



622



624



International Telegraph and Telephone Conference
1949



FRANCE

Abbey, Meuse Valley, Mt. Gerbier de Jonc
1949



Chambers of Commerce
1949

Chateau of Chateaudun
1950



75th Anniversary of the UPU
1949



Raymond Poincare
1950

Charles Peguy, Francois Rabelais
1950



FRANCE

Jules Ferry
1951



Madame Recamier, Marie de Sevigne
1950



Jean-Baptiste de la Salle
1951



Palace of Fontainebleau
1951



Hands Holding Shuttle
1951



Map and Anchor
1951



Marianne
1951



Vincent d'Indy
1951



Abbey
1951



FRANCE

Veterinary Medicine
1951



Military Medicine
1951



Chateau Bontemps
1951



St. Nicholas
1951



Seal of Paris
1951



Maurice Nogues
1951



Georges Clemenceau
1951



Coat of Arms
1951



Charles Baudelaire, Paul Verlaine, Arthur Rimbaud
1951



FRANCE

Chateau du Clos
1951



Chailiot Palace and Eiffel Tower
1951



Gate of France
1952



Observatory, Abbaye aux Hommes
1951



Marshal de Lattre de Tassigny
1952



Battle of Narvik
1952



Chateau de Chambord
1952



Council of Europe
1952



Bir-Hacheim Monument
1952



FRANCE

Abbey of the Holy Cross
1952



Sword and Medals
1952



Dr. Rene Laennec
1952



Mannequin
1953



Leonardo da Vinci
1952



Viaduct
1952



Versailles Gate
1952



Gargantua, Celimene, Figaro, and Hernani
1953



Map and Cyclists
1953



General Leclerc
1953-54



FRANCE

Coats of Arms
1953



Sports
1953



5ET NH

Marianne Issue
Surcharged
1954



Farm Woman, Gallic Cock
1954

Marshal de Lattre
1954



Allied Landings
1954



FRANCE

Crafts
1954



Scenic Views
1954



Fair of Paris
1954



Abbey Ruins
1954



St. Philibert Abbey
1954



FRANCE

View of Stenay
1954



Versailles Gate
1954



Villandry Chateau
1954



Metric System
1954

Duke de Saint-Simon
1954

Legion of Honor Awards
1954



Saint-Cyr Military School
1954



Coats of Arms
1954



728 6



731 6



729 6

FRANCE

Marianne
1955-59



Inventors
1955



Gloved Model
1955

Rotary International
1955



St. Stephen Bridge
1955



741 ②

765

752

FRANCE

Jean Pierre Claris de Florian
1955



Television
1955



Wire Fence and Guard Towers
1955



Jacquemart of Moulins
1955



Electric Train
1955



Jules Verne
1955



Motion Pictures
1955



Jacques Coeur
1955



"La Capricieuse"
1955



Gerard de Nerval
1955



Martinique
1955



768

772

770

780 @ 2.00

769

772

FRANCE

Coat of Arms 1955



Scenic Views 1955



Belfry at Douai 1956



Concentration Camp Victim and Monument 1956



Trench Fighting 1956



FRANCE

Col. Emil Driant
1956



Grand Trianon, Versailles
1956



Latin American & French Culture
1956



Scientists
1956



Leprosarium and
Maltese Cross
1956

"The Smile of Reims" and
Botticelli's "Spring"
1956



St. Yves de Treguier
1956



792



193

FRANCE

Marshal d'Esperey
1956



Miners Monument
1956



Rebuilding Europe
1956



Sports
1956



French Technical Achievements
1956



FRANCE

Antoine-Augustin Parmentier
1956



de Coubertin and Stadium
1956



Homing Pigeon
1957



Portraits
1956



914

915

916

Victor Schoelcher
1957



Sevres Porcelain
1957



Uzes Chateau
1957



FRANCE

Gaston Plante and Storage Battery and Other Designs

1957



823



824

Heroes of the French Underground

1957



Le Quesnoy

1957

Symbols of Justice

1957



Symbols of Public Works

1957



FRANCE

Farm Woman
1957-59



Auguste Comte
1957



Brest
1957



Leo Lagrange and Stadium
1957



Gallic Cock
1957



Scenic Views
1957



FRANCE

United Europe
1957



Roman Amphitheater
1957



Sens River and Other Designs
1957



French Physicians
1958



FRANCE

Portraits
1957

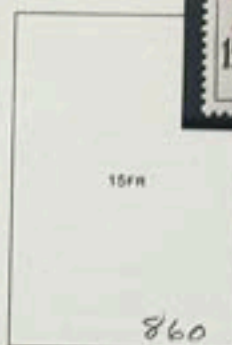

Louis Jacques Thenard
1957



Lourdes Type
1958



French Pavilion
1958



French Scientists
1958



FRANCE

Reconstruction of War-Damaged Cities 1958



Heroes of the French Underground 1958



Sports 1958



893 0



865



896

FRANCE

Senlis Cathedral
1958



Bayeux Tapestry Horsemen
1958



Europa Issue
1958



Soldier's Grave
1958

Foix Chateau
1958



City Halls, Paris and Rome
1958



Arms of Cities
1958-59



FRANCE

Opening of UNESCO Headquarters
1958



Symbols of Learning, Medal
1959



Arc de Triomphe, Flowers
1959

Charles de Foucauld
1959



Miner's Tools and School
1959



Elysee Palace, Evian-les-Bains, Sens River
1959



Gallic Cock
1959



FRANCE

Heroes of the French Underground 1959



French Technical Achievements 1959



Marceline Desbordes-Valmore
1959



Tancarville Bridge
1959



Pilots Goujon and Razonoff
1959



Marianne and Ship of State 1959



FRANCE

Jean Jaures
1959



Europa Issue
1959



Henri Bergson
1959



Polio Victim Holding Crutches
1959

Blood Donors
1959



French-Spanish Handshake
1959



Farm Woman, Sower and Previous Types
1960-61



Avesnes-sur-Helpe, Perpignan
1959



NATO Headquarters
1959



FRANCE

Laon Cathedral and Other Designs

1960



Museum of Art and Industry
1960



Pierre de Nolhac
1960



View of Cannes
1960



Gallic Cock
1960



FRANCE

Centenary of the Annexation of Nice and Savoy

1960



Heroes of the French Underground

1960



Blois Chateau, View of La Bourboule

1960



"Education" and Children

1960



Lorraine Cross

1960



Marianne

1960



FRANCE

Europa Issue
1960



Jean Bouin and Stadium
1960



Lisieux Basilica
1960



General Estienne
1960



Marc Sangnier and Youth Hostel
1960



Coat of Arms
1960



Madame de Stael
1960



Order of Liberation
1960



FRANCE

Birds
1960



Andre Honnorat
1960

St. Barbara School
1960



FRANCE
SEMI-POSTAL STAMPS

Sower Issue Surcharged and Sower Type
1914



Widow at Grave and Other Designs
1917-19

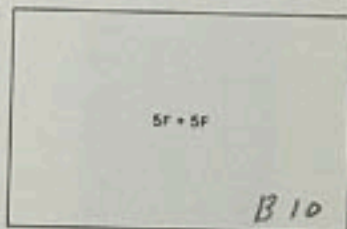
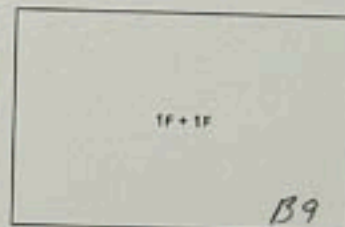
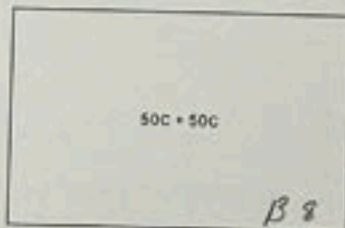
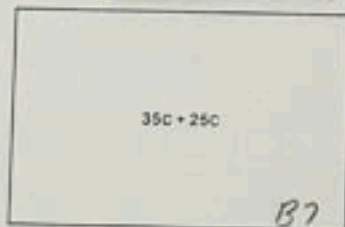
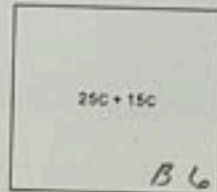
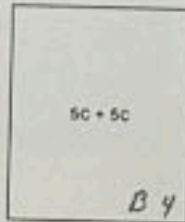

Hospital Ship and Field Hospital
1918

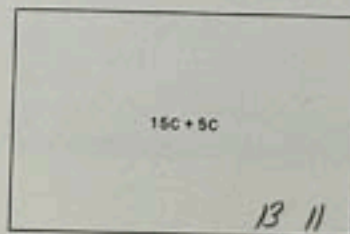



FRANCE
SEMI-POSTAL STAMPS

Semi-Postal Stamps of 1917-19 Surcharged
1922

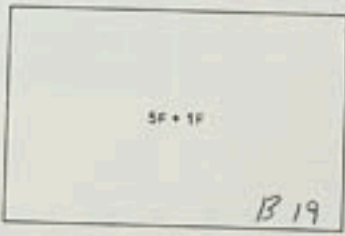

Types of 1917-19
1926-27

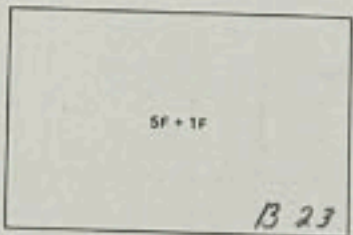

FRANCE
SEMI-POSTAL STAMPS

Sinking Fund
1927

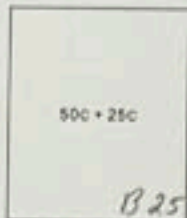

Industry and Agriculture
1928



Sinking Fund
1928



Sinking Fund
1929

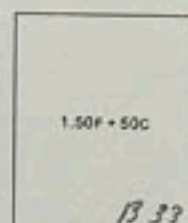

Sinking Fund
1930

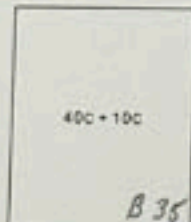

Sinking Fund
1931

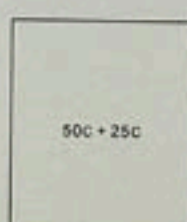

FRANCE
SEMI-POSTAL STAMPS

"The Smile of Reims"
1930



Allegory, French Province
1931

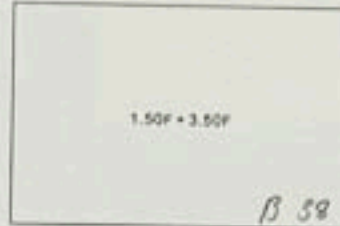

Aid to Intellectuals, Symbolic of Music
1935



Previous Issue Surcharged
1936

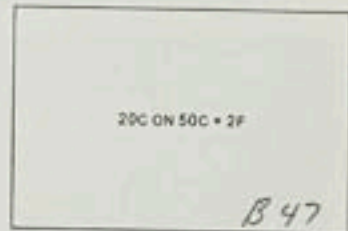

Statue of Liberty
1936-37



Children of Unemployed
1936



Tug of War, Hiking, Foot Race
1937



B 52 H



B 01 3.12

FRANCE
SEMI-POSTAL STAMPS

First Intellectuals Issue
1936-37



111



Second Intellectuals Issue
1938



55c + 10c



FRANCE
SEMI-POSTAL STAMPS

Pierre Loti
1937



"France" and Infant
1937-39



Winged Victory
1937



Monument
1938



French Soldier
1938



Reims Cathedral
1938



Palace of Versailles
1938

Curie Issue
1938



B 76 12.00

19.00

1.8

B 72 5.00

FRANCE
SEMI-POSTAL STAMPS

"France" Welcoming
Her Sons
1938



Victory Parade Passing
Arc de Triomphe
1938



Student and Nurse
1938



Facing Firing
Squad
1939



Red Cross Nurse
1939



Blind Man and Radio
1938



Army Engineer
1939

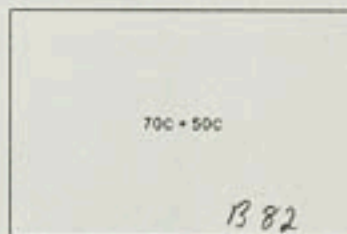

Mother and Child
1939



Ministry of Post,
Telegraph and Telephone
1939



Eiffel Tower
1939



B77 0 4.48



FRANCE
SEMI-POSTAL STAMPS

Aid to Intellectuals
1939-40

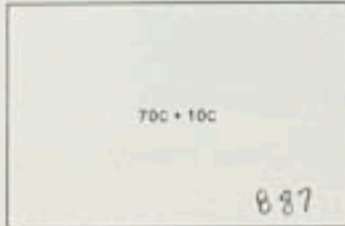

"The Letter"
1939

Mothers and Children
1939

Statue of Widow and Children
1939



FRANCE

SEMI-POSTAL STAMPS

French Soldier, Colonial Trooper
1940



Marshal Joffre, Marshal Foch, General Gallieni, Woman Plowing
1940



World Map Showing French Possessions
1940



B 100 H 7.50

FRANCE

SEMI-POSTAL STAMPS

Doctor, Nurse, Soldier and Family; Nurse and Wounded Soldier
1940



Nurse with Injured Children
1940



Wheat Harvest, Sowing, Picking Grapes, Grazing Cattle
1940



FRANCE
SEMI-POSTAL STAMPS



Prisoners of War
1941

Marshal Petain Surcharged
1941

BDC + 5FR
B169



Science Fighting Cancer
1941



National Relief Fund
1941

Liner Pasteur
1941



Fisherman
1941

World Map
1941

Count de La Perouse
1942



Planes Over Fields
1942

Alexis Chabrier
1942





FRANCE
SEMI-POSTAL STAMPS
Arms of Various Cities
1941

200 + 300
B117



700 + 800
B120



French Colonial Empire
1942

Jean de Vienne
1942



Marshal Petain Regular Issue Surcharged
1942



FRANCE
SEMI-POSTAL STAMPS

Arms of Various Cities
1942



Tricolor Legion
1942



PAIR + ALBINO
IMPRESSION

B147a

FRANCE
SEMI-POSTAL STAMPS

Marshal Petain
1943



1FR + 10FR
ROSE RED

B149

1FR + 10FR
BLUE

2FR + 12FR
ROSE RED



2FR + 12FR
BLUE

B152

Marshal Petain's 87th Birthday
1943

1.20FR + 1.40FR

B153

1.50FR + 2.50FR

2.40FR + 7FR

4FR + 10FR

5FR + 15FR

B157

Civilian Under Air Attack
1943



Families of War Prisoners
1943



FRANCE
SEMI-POSTAL STAMPS

Marshal Petain
1943



Marshal Petain's 87th Birthday
1943



FRANCE
SEMI-POSTAL STAMPS

Famous 16th Century Frenchmen
1943



60c + 80c

B161



2.40FR + 4FR



18th Century Costumes
1943



4FR + 6FR



5FR + 7FR

B172



FRANCE
SEMI-POSTAL STAMPS

Admiral Tourville
1944



Trains
1944

Charles Gounod
1944



French Cathedrals
1944



Marshal Pertain's 88th Birthday
1944



FRANCE

SEMI-POSTAL STAMPS

Famous 17th Century Frenchmen 1944



de Villayer Arms
1944

Sarah Bernhardt
1945

Boy and Girl
1945

Burning Oradour Church
1945



War Victims
1945

TB Patient
1945

Louis XI and Post Rider
1945



FRANCE
SEMI-POSTAL STAMPS

Ruins
1945



Alfred Fournier, Henri Becquerel
1946

Church of the Invalids
1946



"The Letter"
1946

Fouquet de la Varane
1946



French Warships
1946



FRANCE
SEMI-POSTAL STAMPS

Portraits
1946



2100

Churches and Cathedrals
1947



2110

FRANCE
SEMI-POSTAL STAMPS

de Louvois
1947



Submarine Pens,
Shipyard and Monument
1947



Liberty Highway Marker
1947



2200

Centenary of the Revolution of 1848
1948



231



FRANCE
SEMI-POSTAL STAMPS

Fournier
1947



Louis Braille
1948



Etienne Arago
1948



de Choiseul, Post Card
1949



Dr. Calmette
1948



Farmer, Fisherman, Miner, Metal Worker
1949



FRANCE
SEMI-POSTAL STAMPS

Portraits
1949



The Seasons
1949



FRANCE
SEMI-POSTAL STAMPS

Postman
1950



Busts
1950



Mail Car Interior
1951



Portraits
1950



FRANCE
SEMI-POSTAL STAMPS

Portraits
1951



5FR + 1FR

259



12FR + 4FR

261



Stagecoach of 1844
1952



"Child at Prayer", "18th Century Child"
1951



FRANCE
SEMI-POSTAL STAMPS

Portraits
1952



8FR + 2FR

B267



18FR + 5FR

B270



Cupid
1952



Count d'Argenson
1953

12FR + 3FR

275

FRANCE
SEMI-POSTAL STAMPS

Portraits
1953



Madame Vigee-Lebrun, Return from Baptism
1953

Count de La Vallette
1954



FRANCE
SEMI-POSTAL STAMPS

Portraits
1954

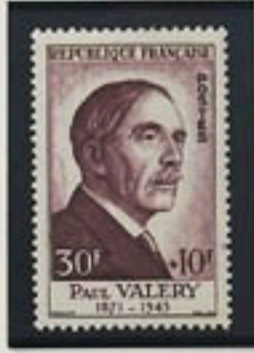
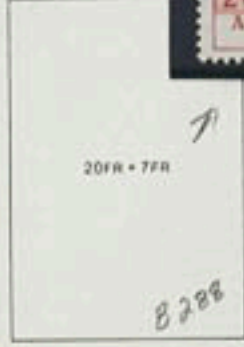

Balloon Post, 1870
1955



The Sick Child, Young Girl with Doves
1954



FRANCE
SEMI-POSTAL STAMPS

Portraits
1955



Francois of Taxis
1956



Child with Cage, Child with Goose
1955



FRANCE
SEMI-POSTAL STAMPS

Portraits
1956



Genoese Felucca
1957



Peasant Boy, Gilles
1956



FRANCE
SEMI-POSTAL STAMPS

Portraits
1957



12FR + 3FR

B318



15FR + 5FR

315



Motorized Mail Distribution
1958

15FR + 5FR

320

Blind Man and Beggar, Women Beggars
1957



FRANCE
SEMI-POSTAL STAMPS

Portraits
1958



Plane Landing at Night
1959



St. Vincent de Paul, J. H. Dunant
1958





FRANCE
SEMI-POSTAL STAMPS

Portraits
1959



Regular Issue Overprinted
1959

Ship Laying Cable
1960



Charles Michel de l'Epee, Valentin Haüy
1959



FRANCE
SEMI-POSTAL STAMPS

Portraits
1960



Refugee Girl Amid Ruins
1960



St. Martin
1960



FRANCE
SEMI-POSTAL STAMPS

Letter Carrier
1961



Designs from "Miserere"
1961



Famous Men
1961



Medieval Royal
Messenger
1962



Rosalie Fragonard, Child Dressed as Pierrot
1962



FRANCE
SEMI-POSTAL STAMPS

Portraits
1962



150 + 50

B 359



300 + 100

B 362



Portraits
1963



Roman Chariot
1963



FRANCE
SEMI-POSTAL STAMPS

Portraits
1963



Child with Grapes, The Fifer
1963



Post Rider, 18th Century
1964



20th Anniversary of Liberation from the Nazis
1964



FRANCE
SEMI-POSTAL STAMPS

President Rene Coty and Other Portraits
1964

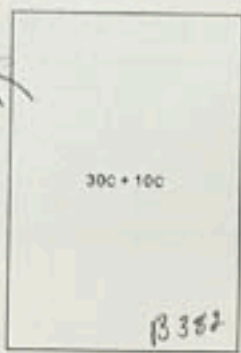

Jean Nicolas Corvisart, Dominique Larrey
1964

Infant with Spoon, Coco Writing
1965



Portraits
1965



FRANCE

SEMI-POSTAL STAMPS

Packet "La Guienne"
1965



Engraver Cutting Die
1966



Famous Men
1966



Victory of Verdun
1966



First Aid
1966





FRANCE

SEMI-POSTAL STAMPS

Emile Zola and Other Portraits
1967



30C + 10C

B404



30C + 10C

B407

Letter Carrier, 1865
1967

Ivory Carvings
1967



Grenoble Winter Olympics
1968

30C + 10C

B411



95C + 35C

B415



FRANCE

SEMI-POSTAL STAMPS

Francois Couperin and Other Portraits

1968



Rural Mailman, 1830

1968



Mailmen's Omnibus, 1881

1969



The Seasons by Nicolas Mignard

1968-69



40C + 15



FRANCE

SEMI-POSTAL STAMPS

General Marceau and Other Portraits

1969



Liberation of Paris

1969

Liberation of Strasbourg

1969

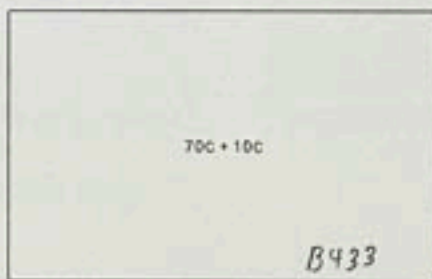

B432



FRANCE

SEMI-POSTAL STAMPS

Philibert Delorme and Other Famous Men

1970



City Mailman, 1830
1970

Dissay Castle Frescos
1970

"Life and Death"
1970



Marshal de Lattre de Tassigny
1970

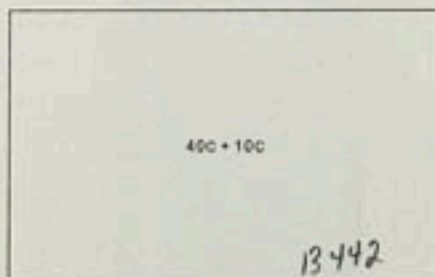



FRANCE
SEMI-POSTAL STAMP

Portraits
1971



Greuze Paintings
1971

Army Post Office, 1914-18
1971



Rural Mailman
1972

Desgenettes, Broussais
1972



FRANCE
SEMI-POSTAL STAMPS

Portraits
1972



Portraits
1973

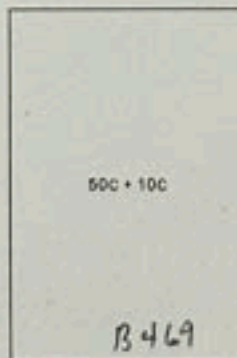
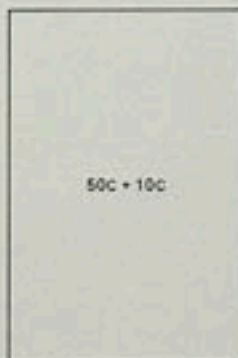
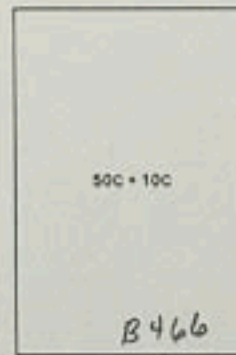

FRANCE
SEMI-POSTAL STAMPS

Mary Magdalene, Mourning Woman
1973

Mail Coach, 1835
1973



Portraits
1974



Automatic Letter Sorting
1974



Liberation from the Nazis
1974

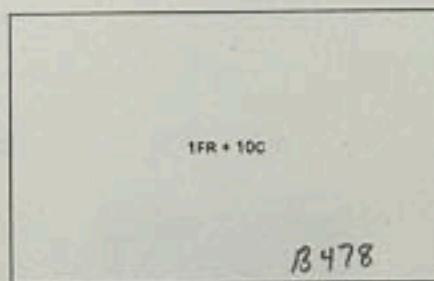

FRANCE
SEMI-POSTAL STAMPS

"Summer", "Winter"
1974

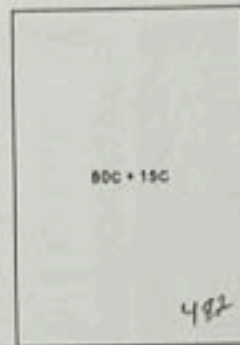

"Spring", "Fall"
1975

Portraits
1975

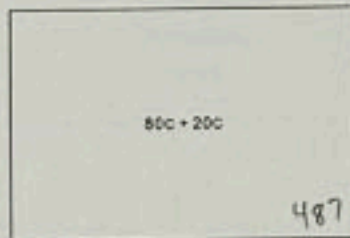

Mailman's Badge
1975



Sage Type
1976



FRANCE
SEMI-POSTAL STAMPS

Portraits
1976



Anna de Noailles
1976



Brou Cathedral Sculptures
1976



Relay Station Sign
1977



Portraits
1977



FRANCE
AIR POST STAMPS

Merson Issues Surcharged
1927



Berthelot and Pasteur Issues Surcharged
1928



View of Marseille, Church of Notre Dame at Left
1930-31



With Perforated Initials "E.I.P.A.30"



C5



C6



FRANCE
AIR POST STAMPS

Bleriot's Monoplane
1934



Plane Over Paris
1936



3.50F



50F
EMERALD

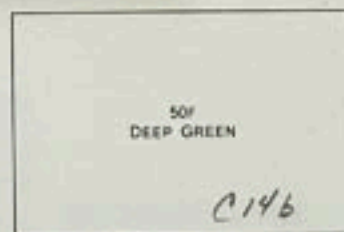

50F
DEEP GREEN

C146

Airplane and Galleon, Airplane and Globe
1936

Monoplane Over Paris
1936

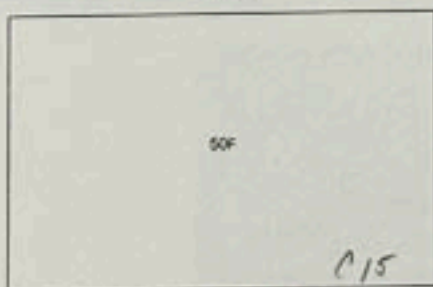

50F

C15





C 30 DK BLUE

FRANCE
AIR POST STAMPS

Centaur and Plane and Other Designs
1946-47



Ile de la Cite, Paris, and Gull
1947



Air Views of French Cities
1949-50



FRANCE

AIR POST STAMPS

Alexander III Bridge and Petit Palace, Paris
1949



Planes
1954



Maryse Bastie and Plane
1955



FRANCE
AIR POST STAMPS

Planes
1957-59



Plane Types of 1954-59
1960



Color Variety



35 0



34 0



C38 0 MORE GREEN

FRANCE
AIR POST STAMPS

Jet Plane
1965



Concorde
1969



Mermoz, de Saint-Exupery and Concorde
1970



FRANCE
AIR POST STAMPS

Balloon Post
1971

Didier Daurat, Raymond Vanier
1971



Planes Over Atlantic
1977



Aviation Pioneers
1972-73

Concorde
1976



Aerospace and Space Show
1979

Plane Over Flight Route
1978

Nonstop Transatlantic Flight
1980



C53

FRANCE

AIR POST SEMI-POSTAL STAMPS

Antoine de Saint-Exupery and Colonel Jean Dagnaux
1948



Modern Plane and Ader's "Eole"
1948



FRANCE

POSTAGE DUE STAMPS

Numerals of Value in Banner
1882-92

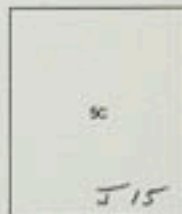
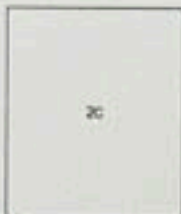

60.00

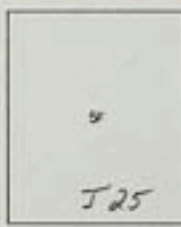

Numerals of Value in Banner
1884

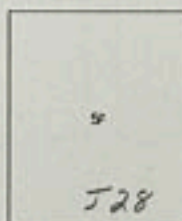

FRANCE
POSTAGE DUE STAMPS

Numerals of Value in Banner
1893-1941



15c



25c
J33



30c
ORG. RED

40c

45c



50c
LILAC
J38a



1c
ROSE ON
STRAW

1c
RED BRN.
ON STRAW



2c
RED ORG.

2c
BRT. VIOLET

3c

4c
J45A

Recouvrements
1908-25



20c

30c

50c

60c
J51

FRANCE
POSTAGE DUE STAMPS

Recouvrements Surcharged
1917



40C ON 50C

DOUBLE
SURCHARGE
40C ON 50C
J53a

Recouvrements Surcharged
1926

50C ON 10C
J54

60C ON 1C

1F ON 50C

2F ON 50C
J55

Recouvrements
1927-31

1C
J58

10C



1F
VIOLET



2F
BLUE



Recouvrements Surcharged
1929-31

1.20F
ON 2F

5F ON 1F

UN FRANC
ON 50C
J68

FRANCE
POSTAGE DUE STAMPS

Sheaves of Wheat
1943-46



Sheaves of Wheat
1946-53



Sheaves of Wheat
1960

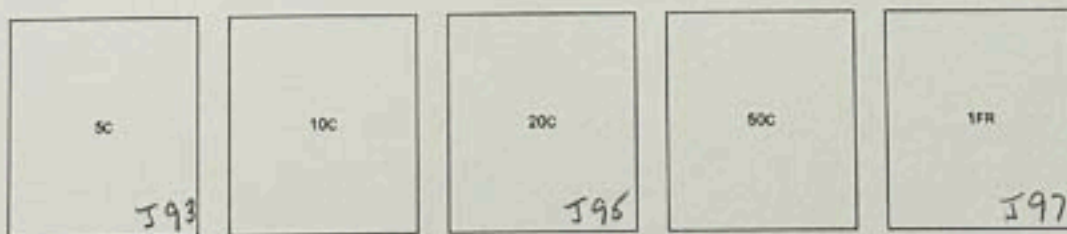

FRANCE
POSTAGE DUE STAMPS

Flowers
1964-71



MILITARY STAMP

Flag
1964



FRANCE
MILITARY STAMPS

Regular Issues Overprinted "F.M."
1901-39

15C
ORANGE
M1

INVERTED
OVERPRINT
15C
ORANGE

15C
PALE RED

15C
SLATE GRN.

NO PERIOD
AFTER "M"
15C
SLATE GRN.
M3a

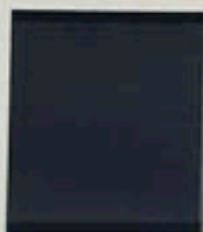

NO PERIOD
AFTER "M"
10C
ROSE



INVERTED
OVERPRINT
10C
RED
M5a

50C
VERMILION

NO PERIOD
AFTER "M"
50C
VERMILION

PERIOD IN
FRONT OF "F"
50C
VERMILION

50C
ROSE RED

NO PERIOD
AFTER "M"
50C
ROSE RED

INVERTED
OVERPRINT
50C
ROSE RED
M7b

65C
BRT. ULTRA.

NO PERIOD
AFTER "M"
65C
BRT. ULTRA.

90C
ULTRA
M9

FRANCE
MILITARY STAMPS

"F. M."
1946-47



FRANCE
NEWSPAPER STAMPS

Coat of Arms
Imperforate
1868



Perforated

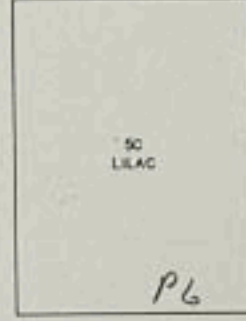

Blanc Issue
Surcharged
1919



Sower Issue
Surcharged
1933



P7



P8

FRANCE

OCCUPATION STAMPS

Issued Under German Occupation (Alsace and Lorraine)

Numerals

Network with Points Up

1870

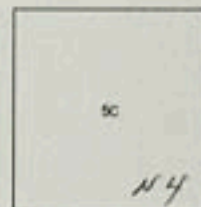

75.00

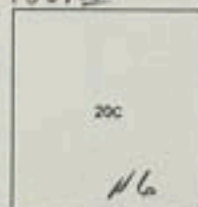

100.00

N6



N7a

N1a 75.00

Network with Points Down

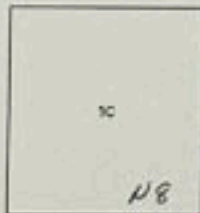

N8

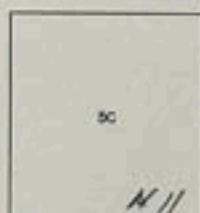

N11

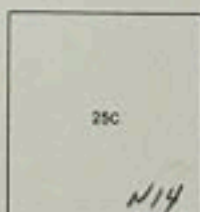

N14

50.00

FRANCE

OCCUPATION STAMPS

Issued Under German Occupation (Alsace and Lorraine)

Official Imitations of 1870 Issue
Network with Points Down



FRANCE
OCCUPATION STAMPS

Issued Under German Occupation (Alsace and Lorraine)

German Stamps of 1905-16 Surcharged
1916

3C ON
3PF

N15



8C ON
7 1/2PF



25C ON 20PF
ULTRAMARINE

N16a

40C ON
30PF

50C ON
40PF

N22

75C ON
60PF

1F ON
80PF

N24

1F25C ON 1M

N25

2F50C ON 2M

N26

Double Surcharge

1F25C ON 1M

N25a

2F50C ON 2M

N26a

FRANCE
OCCUPATION STAMPS
Issued Under German Occupation

German Stamps of 1933-36 Overprinted for Alsace
1940



FRANCE
OCCUPATION STAMPS

Issued Under German Occupation

German Stamps of 1933-36 Overprinted for Lorraine
1940



FRANCE

OFFICIAL STAMPS FOR THE COUNCIL OF EUROPE

Regular Issue Overprinted
1958



Council of Europe Flag
1958-59

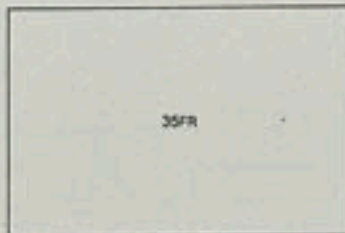
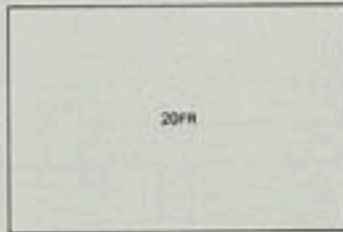
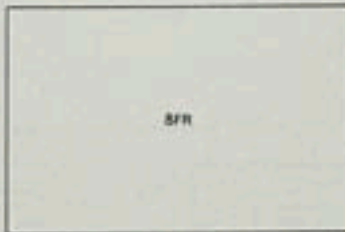

FRANCE

OFFICIAL STAMPS FOR UNESCO

Khmer Buddha and Hermes by Praxiteles
1961-65



Book and Globe
1966



Human Rights Flame
1969-71

